



<i>EAN code</i>	8034122370514
<i>Model Code</i>	FNPLS36I6SS-R Plus - island - 36" (90cm) - inox - 600 CFM
<i>Collection</i>	Silence - NRS

FEATURES AND PROPERTIES

<i>Materials/Finishes</i>	Scotch brite stainless steel (AISI 304)
<i>Lighting</i>	Strip LED Dynamic Light (2700K - 5600K) Dimmable lighting
<i>Control</i>	Electronic control
<i>Installation type</i>	Island
<i>Ducting type</i>	External ducting/Recirculating
<i>Filters</i>	Metallic grease filter, removable and washable Carbon.Zeo Microtech renewable filter (optional)
<i>Dimensions</i>	36 in
<i>Features</i>	NRS technology for a quieter kitchen Perimeter suction SRS Speed reduction system

OPTIONAL ACCESSORIES

Code	Description
KACL.1039	Carbon.Zeo Microtech renewable filter
KACL.400	Silent / Conveyor NRS
105080053	Remote control
KACL.572#I	Extension H1200 Island - Inox

ELECTRICAL CONNECTION AND CONSUMPTION

Maximum consumption 340W
 Voltage/Frequency 110-120V 60Hz
 Connection type Hood comes standard with Nema 5-15P power cord

BLOWER PERFORMANCE

Motor 600 CFM

TECNICAL SPECS OF COOKERHOOD WITH 600 CFM NRS MOTOR

Motor Speed	SRS 2*		SRS 3*	
	1	2	3	4
CFM (rated at the motor)	210	295	395	600
Sones (estimated value)	1	2	3	4.25
Duct Size	6"	6"	6"	6"

*If activated SRS has 2 settings; 3 speed max & 2 speed max

WEIGHTS AND DIMENSIONS

Gross weight 109 lbs
 Net weight 93 lbs
 Packaging dimensions L 43 in H 27 in D 35 in
 Notes Recommended mounting height from cooking surface to hood bottom: 24" - 35"

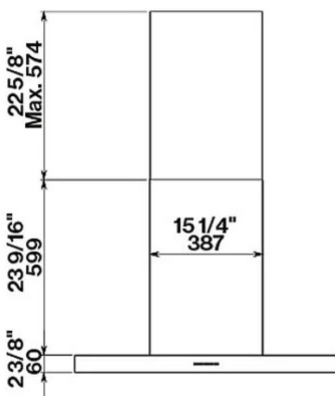

Frontal view

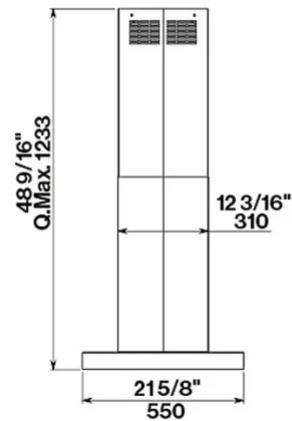

Side view

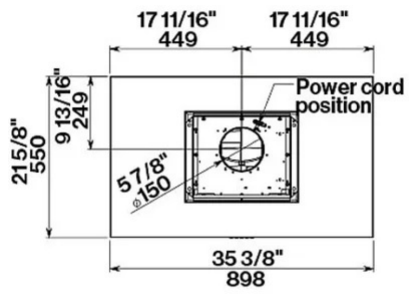

Top view